

**Shower Curtain Rod – 1-1/4" diameter [Ø32] Bar, Stainless Steel – Various Lengths**

Shower/Tub Accessories

MasterFormat Section 10 28 13

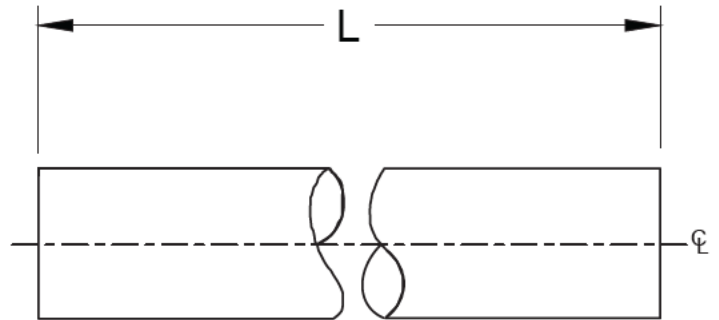
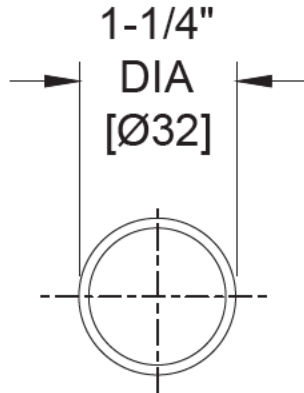

Scan for Information



**SUSTAINABILITY/LEED**

MR 4.1 (1) MR 6 (1) EQ 4.2 (1)  
MR 4.2 (1) EQ 4.1 (1) EQ 4.4 (1)

**NOTE:**  
ALL DIM'S INCH (MM)  
ILLUSTRATION FOR REF ONLY AND NTS

**PRODUCT OVERVIEW**

Tubing is 18 gauge, 1-1/4" OD [Ø38] with a satin finish. Choose specified length. Select length in inches (i.e. 048, 060, 120) to create Part Spec Order Number (i.e. 1204- 060). Rod is installed in straight section between two (2) mounting flanges. Rods longer than 72" [1829] require ceiling hanger Model #1204-C. For use with standard shower curtain Model #1200 or #1200-V having 72" [1829] length and standard hooks Model #1200-SHU unit should be installed with rod centerline 74-1/2" [1892] AFF or 67" [1702] above tub rim to obtain 6" [152] bottom overlap.

**KEY FEATURES & SPECIFICATIONS**

- Type 304 Stainless Steel - Satin Finish
- 18 gauge Tubing
- Wall Mounted
- 1-1/4" Dia. [Ø32] Bar

Distributed by  
**www.Ameraproducts.com**  
Phone: (800) 608-6568  
Fax: (409) 840-5545  
info@ameraproducts.com

**OPERATION & MAINTENANCE**

Rod is held captive by flanges when installed properly. Rod may rotate in flanges if turned by hand. Correctly installed rod and flanges will support specified shower curtain(s) hung on hooks 1200-SHU or others (by others). Rod will bend and pull from flanges if significant body weight is suspended.

**TECHNICAL INFORMATION / PRODUCT PROPERTIES**

Property	Value
Dimensions	1-1/4" [Ø32] Diameter. Maximum length 120" [3048]
Construction	Type 304 Stainless Steel - Satin Finish 18 gauge Tubing
Mounting	Wall Mounted
Materials	<u>Tubing:</u> 18 gauge (.048" [1,22] thick) type 304 stainless steel, 1-1/4" Dia. [Ø32]. Exposed surfaces are satin finish. Edges and corners are radiused and burr free.

**INSTALLATION**

Rod is installed in straight section between two (2) mounting flanges. Rods longer than 72" [1829] require ceiling hanger Model #1204-C. For use with standard shower curtain model #1200 or #1200-V having 72" [1829] length and standard hooks Model #1200-SHU unit should be installed with rod centerline 74-1/2" [1892] AFF or 67" [1702] above tub rim to obtain 6" [152] bottom overlap.

**SIZE OPTIONS**

<b>Options:</b>	1204-30: 30" [762]	1204-36: 36" [914]
	1204-42: 42" [1067]	1204-48: 48" [1219]
	1204-54: 54" [1372]	1204-60: 60" [1524]
	1204-66: 66" [1676]	1204-72: 72" [1829]
	1204-78: 78" [1981]	1204-84: 84" [2134]
	1204-90: 90" [2286]	1204-96: 96" [2438]



**Distributed by**  
**www.Ameraproducts.com**  
 Phone: (800) 608-6568  
 Fax: (409) 840-5545  
 info@ameraproducts.com

**WARRANTY**

One (1) Year from date of Invoice