

# CABINETS - CATO

## INSTALLATION & MAINTENANCE GUIDE | 14I-120

Distributed by  
www.Ameraproducts.com  
Phone: (800) 608-6568  
Fax: (407) 840-5542  
info@ameraproducts.com



### GENERAL:

Cato's affordable fire extinguisher series, manufactured in the U.S, provides a dent and rust proof alternative to metal. Various models are available, modify installation accordingly.

### TOOLS/HARDWARE NEEDED:

- 4 - Screws specific to wall type (not included)
- Drill (optional, as needed)

### SURFACE MOUNT INSTALLATION:

Review the full instruction and photos to familiarize yourself with this process before beginning the installation process.

1. Remove all hardware and glazing, unlock cabinet if lock provided (figure 1).
2. If provided, attach break tool to cabinet as instructed on page 2 (figure 4).
3. Place cabinet in position level to floor, and mark location of attachments on studding using 1/4" (6.35 mm) holes as marking guides. Cabinet must be attached by at least 4 points, 2 of which must be in framing members (figure 2). See page 3 for mounting hole templates.
4. Remove cabinet and drill 1/4" (6.35 mm) holes through studs at marked points. Install plastic wall anchors in no more than 2 places if needed. For masonry walls, install expansion shields in wall at marked points.
5. Place cabinet in position and attach with self-drilling screws, or for masonry, appropriate screws for expansion shield.
6. Place fire extinguisher in cabinet.
7. Remove protective plastic from plexiglass.
8. Align glazing on inside of door and install trim by snapping into place.
9. Assemble all pieces (figure 3).
10. Lock cabinet if hex key and lock is provided. Place key in lock and turn 1/4 turn clockwise to open and 1/4 counterclockwise to lock.

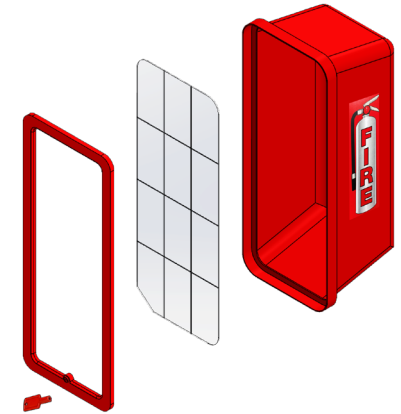


Figure 1: Cato Chief Assembly Tub, Acrylic, Frame, Hex Key

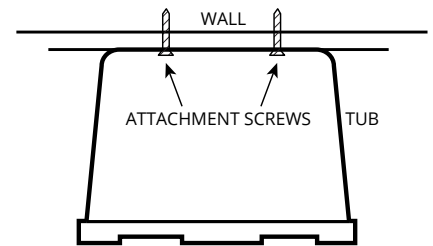


Figure 2: Top Down View Screw Installation

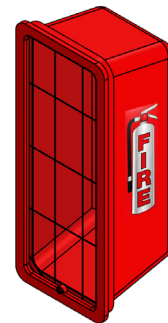


Figure 3: Cato Chief Assembled

### BREAK TOOL INSTALLATION (Chief only):

1. Insert removable fastener (which is already attached to breaker bar or hammer) into pre-drilled 9/32" hole. When frame is placed on cabinet it will effectively lock the fastener in place (figure 4).
2. To remove fastener, remove frame and push fastener out from the inside using fingers.

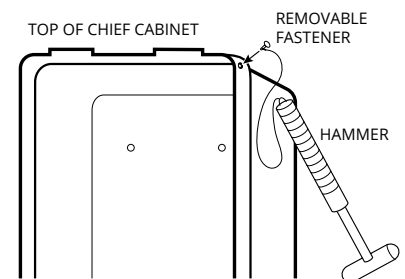


Figure 4: Hammer Assembly



JL INDUSTRIES



CATO

9702 Newton Ave S. Bloomington, MN 55431 | Many Locations Across North America

Installation & Maintenance Guide |  
14I-120

REV F 4-19-2024



### OPTIONAL EXTINGUISHER TRAY INSTALLATION:

Cato's extinguisher tray is designed to allow air to flow under the extinguisher to alleviate corrosion due to condensation.

1. Place the tray, flat side up, balls side down, in the bottom of the cabinet. The longer part of the tray should be placed in the width of the cabinet (from side to side).
2. Place extinguisher on the tray (figure 5).
3. This tray is designed to allow air to flow under the extinguisher to alleviate corrosion due to condensation.



Figure 5  
Extinguisher Tray

### SEMI RECESSED INSTALLATION:

Review the full instruction and photos to familiarize yourself with this process before beginning the installation process.

1. Remove all hardware and glazing, unlock cabinet if lock provided. Do not remove the Styrofoam protection inside trim, leave in for install (figure 6).
2. Frame in above, below and at both sides of the cabinet opening (figure 7). Note: On load bearing walls, the studs must be doubled on either side of the cabinet tub. If a stud must be cut to install the cabinet, a load bearing header must be installed above the cabinet tub.
3. Place cabinet in position and mark location of attachments on studding using 1/4" (6.35 mm) holes as marking guides. Cabinet must be attached by at least 4 points, 2 of which must be in framing members.
4. Remove cabinet and drill 1/4" (6.35mm) holes through studs at marked points. Install plastic wall anchors in no more than 2 places if needed. For masonry walls, install expansion shields in wall at marked points.
5. Place cabinet in position and attach with self-drilling screws or for masonry, appropriate screws for expansion shield.
6. Check cabinet door assembly for freedom of movement. If it binds, shim as necessary.
7. Remove protective plastic from plexiglass and install decal.
8. Place fire extinguisher in cabinet. Lock cabinet if lock provided.



Figure 6  
Semi Recessed Cabinet Back View

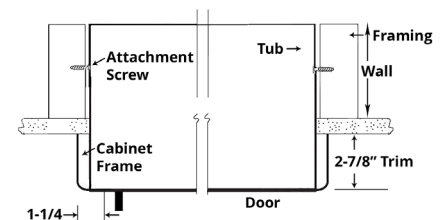


Figure 7  
Semi Recessed Installation

### MAINTENANCE:

Cato's fire extinguisher cabinets and accessories are designed to to be maintenance-free.

- Keep debris and dirt away from the hinges and outer surface of the cabinet for optimal operation.
- If metal latches are present, locks or hinges need to be lubricated, use a "3 in 1" type light oil, removing excess with a cloth.
- Use a mild solution of detergent and water to clean the surface. Rinse well.

# CABINETS - CATO

## INSTALLATION & MAINTENANCE GUIDE | 14I-120

Distributed by  
www.Ameraproducts.com  
Phone: (800) 608-6568  
Fax: (407) 840-5542  
info@ameraproducts.com

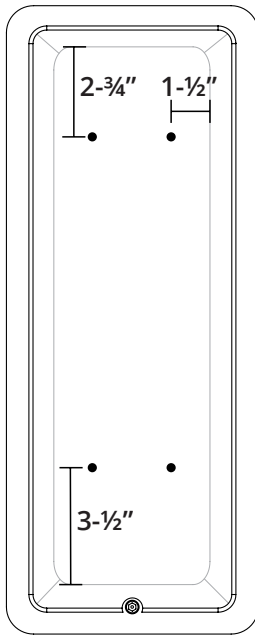


### SURFACE MOUNT TO WALL INSTALLATION, MOUNTING HOLE TEMPLATES

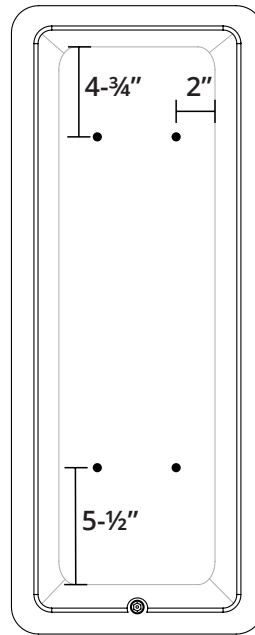
Note: Holes are measured from back edge. Images are not to scale, use measurements.

#### CHIEF SERIES:

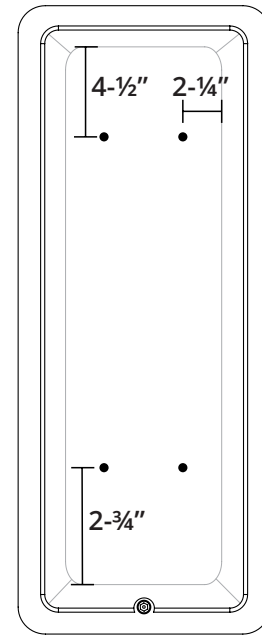
**Fig. A**  
Models: 10501, 10551  
Previous Model: 105-5



**Fig. B**  
Models: 11001, 11051  
Previous Model: 105-10

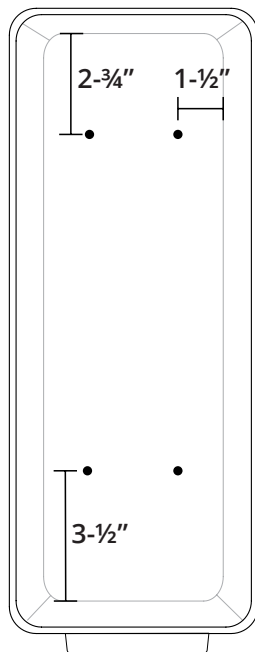


**Fig. C**  
Models: 12001, 12051  
Previous Model: 105-20



#### WARRIOR SERIES:

**Fig. D**  
Models: 95051, 95052, 95551, 95552  
Previous Model: 95-5



**Fig. E**  
Models: 95101, 95102, 95151, 95152  
Previous Model: 95-10

